

Gas OCF Waste Oil Dispose Kit

826-3190 (2 battery), 826-3184, (3-5 battery)

Follow these instructions to add the necessary plumbing and electrical fittings to connect a gas OCF fryer to a waste oil system without tank switches.

1. Remove power from fryer and external electrical connections. Remove from hood to gain access to the back.
2. Remove the fryer lower back.
3. Remove bolts supporting oil-return manifold and slowly pull manifold away from fryer. This will expand slightly the flex lines and produce access space. **See figure 1.**
4. Remove and discard the tube connecting the solenoid to the drain manifold and the tube connecting the pump to the oil return manifold. **See figure 8.** Some oil may leak out of the lines at the manifold.
5. Remove the solenoid on the rear oil return manifold and the solenoid attached to the filter pump and plug the ports they occupy. **See figure 8.**
6. Trace the solenoid wiring to its Molex plug and push the pins from the plug and discard the solenoids.
7. Remove the JIB cradle and set aside.
8. Remove screws supporting the ATO box shelf. **See figure 2.** Allow it to sit on the floor inside the cabinet.
9. Position the waste oil plumbing assembly, and attach using provided screws into existing holes. **See figures 3, 5, 6, 7, 8, 9 and 11.**
10. Route flex lines. **See figure 8.**
11. Route the plumbing assembly control arm through the fryer from the front to the activation arm on the assembly. The control arm slides through the upright cabinet support on two battery systems. **See figure 11.**
12. Position the locking control arm device to prevent the forward motion of the control arm in the locked position.
13. Unplug both wires from the far left oil return switch terminals as viewed from the front of the unit. **See figure 4.**
14. Using the provided harness plug both ¼” pigtail ends to the far left oil return switch terminals referenced in step 13 **See figure 4.**
15. Plug the wires removed in step 13 to the open terminals of the ¼” pig tail ends attached to the oil return switch in step 14. **See figure 4.**
16. Plug the other ends of the new jumper wire harness wires into the terminals on the dispose valve switch on the oil disposal assembly. **See figures 3 and 4.**
17. Attach waste connection assembly to rear cabinet channel using provided 1/4-20 bolts into existing holes. **See figure 10.**
18. Reposition the ATO box and JIB cradle.
19. Reattach the rear oil manifold, ensuring no flex lines are stressed.

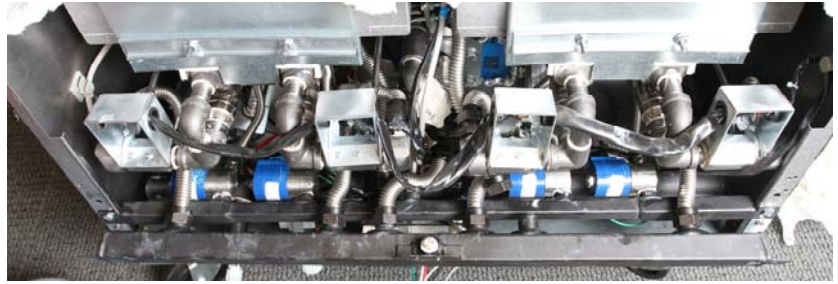

Figure 1: The oil-return manifold is shown pulled from the frame to expand the flex lines and to ease access.



Figure 2: The ATO box is shown in the JIB cabinet. Remove the screws securing its shelf and lower to the floor to ease access for positioning the plumbing assembly.

See figures 9 and 11.

20. Attached provided labels.
21. Replace the fryer back.
22. Attach waste oil lines.
23. Restore power, return to the hood and test. See dispose oil operation instructions on page 4.

Leave the last page of these instructions with the store.

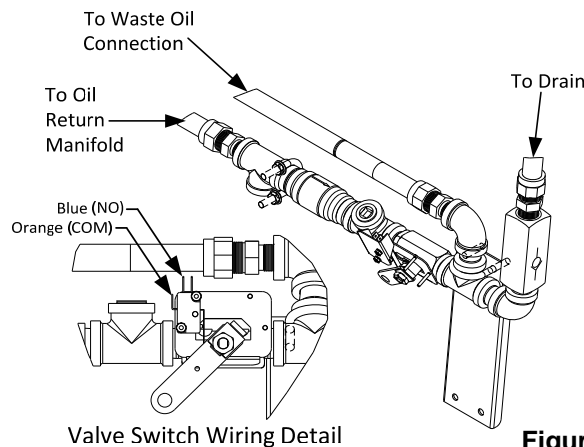

Figure 3

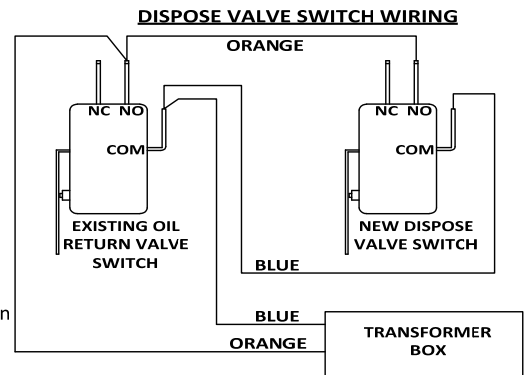

Figure 4

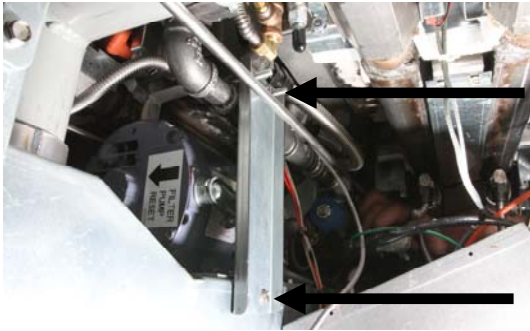

Figure 5: The framework holding the new plumbing assembly is shown in place, secured with existing holes at bottom, using provided screws.

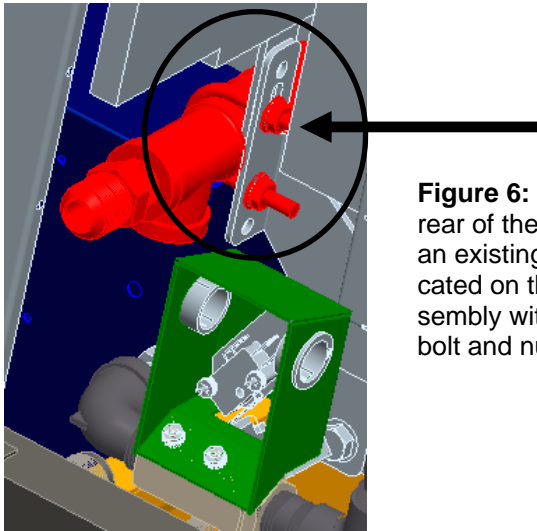

Figure 6: Attach the rear of the assembly to an existing bracket located on the pump assembly with supplied U-bolt and nuts.

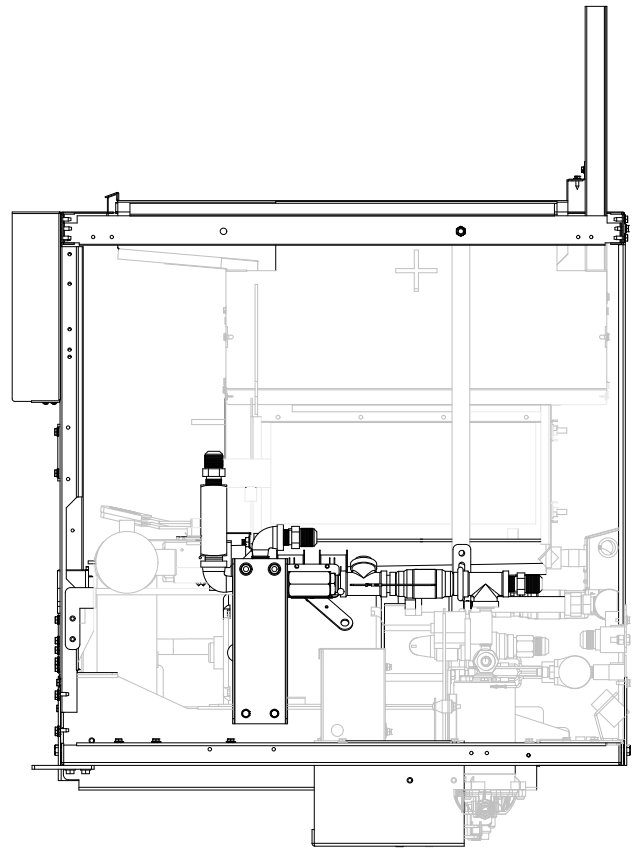

Figure 7: The outline of the new plumbing is shown in bold.

Remove solenoid and plug the manifold with provided plug.

Remove Flexline and solenoid and plug the line with provided plug.

Remove solenoid vent line

Waste oil assembly → Waste

Plug off the two solenoid ports.

Plumbing Before Kit Installation

Plumbing After Kit Installation

Figure 8: The routing of the oil and vent lines are shown before the kit installation (left) and after installation on right.

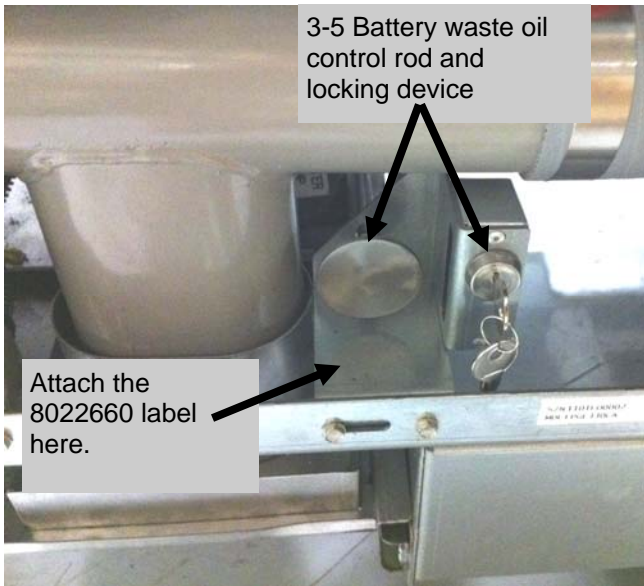

Figure 9: The 3 -5 battery and larger waste valve handle is assembled through the lock bracket and attached adjacent to the drain down spout shown in place.

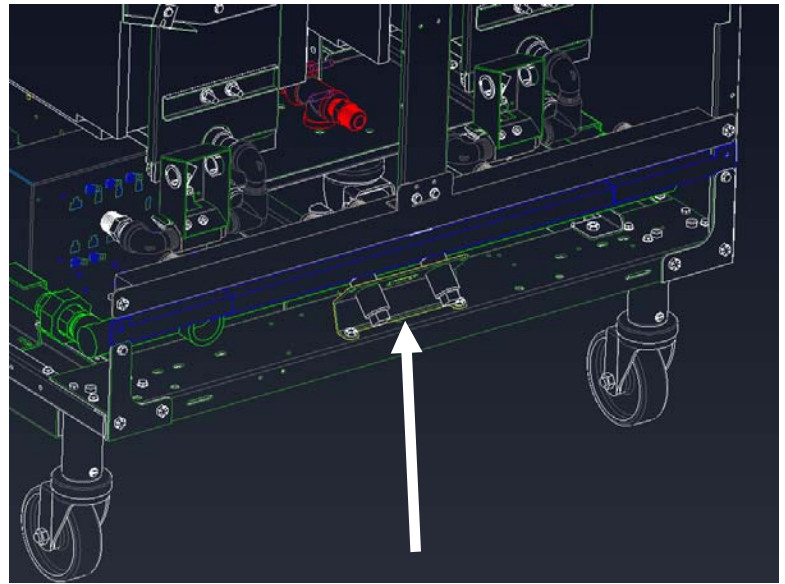

Figure 10: Attach waste oil connection assembly to rear channel as shown with provided 1/4-20 bolts.

To Dispose of Waste Oil

1. Ensure filter pan is prepared for filtration.
2. Heat the oil to cooking temperature prior to disposal.
3. If the filter menu is enabled choose the DISPOSE option. If the filter menu is disabled, turn the controller to OFF.
4. Drain vat into filter pan.
5. Unlock dispose valve handle.
6. Ensure there is adequate room on dispose tank prior to disposing.
7. Pull the oil disposal valve handle and the pump will engage and empty the filter pan to the waste oil tank. If the waste tank is full the oil may return to the filter pan. On some systems, oil may overflow the bulk waste tanks.
8. Once dispose is complete, clean out vats and fill with fresh oil.

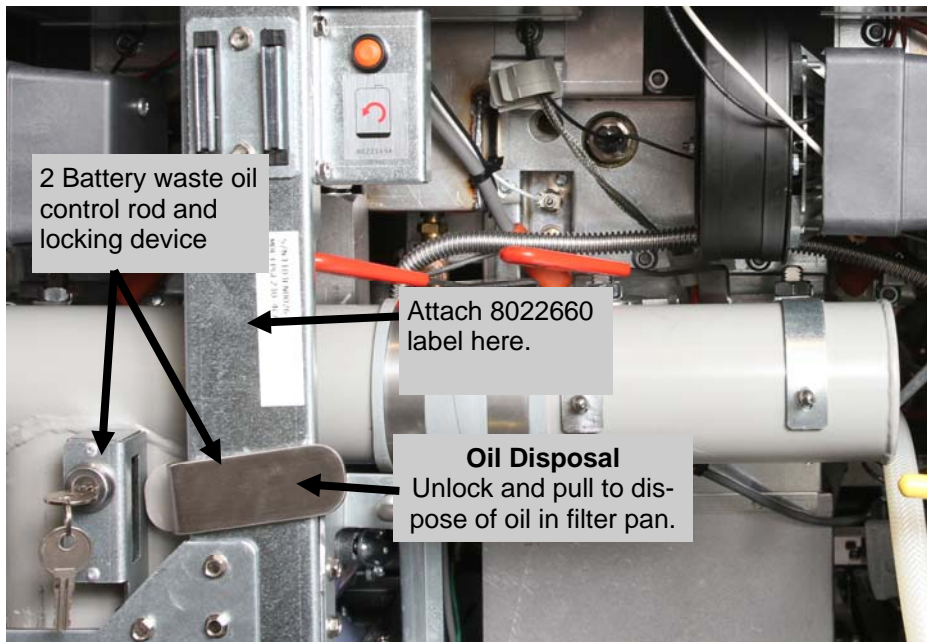

Figure 11: The 2 battery assembly dispose waste handle shown in place.